



15ml Dial-a-Dose (0.5ml increments)

# Injector

RE-ORDER CODE: PAS1263

[njphillips.com](http://njphillips.com)

*The Phillips 15ml Automatic Injector is a quality precision instrument, designed for mass treatment of livestock.*

*Given normal care it will last indefinitely. As components in this instrument may be affected by solvents in some commonly used farm chemicals no responsibility will be accepted by the manufacturer should the instrument be used with such products.*

## **BEFORE INJECTING**

### **Always read the label.**

Check the label on the pharmaceutical manufacturer's container for dose rates, precautions, and safety information prior to use.

### **Use only the recommended dose rate.**

Use only the pharmaceutical manufacturer's recommended rates. Refer to the pharmaceutical manufacturer's dose rate chart or specification. NJ Phillips Pty Limited will take no responsibility if the injector is used for any other purpose than specified or used contrary to the pharmaceutical manufacturer's dose rate specifications.

## **THE MAIN FEATURES WHICH MAKE THIS INSTRUMENT SO PRACTICAL:**

### ***EASY ACCESS INTO INJECTOR – Figure 1***

To access the internal parts of the injector, it is important to hold the injector as the return spring will force the handle and lever apart under pressure. Now simply remove the handle clip (2) by sliding it out the groove in the handle. It is important to hold the injector while doing this as the return spring will force the handle and lever apart under pressure. When the pushrod assembly comes free of the handle, access is then able to be made to the inlet valve spring assembly and to clean or replace the piston o-ring. When re-assembling, ensure the piston o-ring is lubricated with NJ Phillips Lubricant, then slide the pushrod assembly back into the handle, ensuring the return spring is located correctly in the handle and lever set. Then, secure the pushrod assembly by sliding the handle clip (2) back into the slot within the handle.

### ***SUPERIOR VALVE DESIGN – Figure 2 & 3***

The inlet valve (3) is housed in the front of the push rod and is accessed by removing the inlet valve spring assembly by holding the spring and turning in an anticlockwise direction to pull out of the front of the piston. To reassemble once cleaned or being replaced, re-lubricate with NJ Phillips Lubricant, locate the inlet valve (3) of the assembly into the front of the piston and gently twist and push the valve spring assembly into the retaining clips.

The delivery valve is located at the rear of the needle mount. The delivery valve may be readily removed for cleaning.

### ***TO SET DOSE – Figure 4***



**Ensure the handle and lever are in the fully open position before changing the dose. Do not squeeze to change the dose as this will damage the injector.**

The dose can be set from 0.5ml to 15ml in 0.5ml increments. The dose is very easily set. You simply turn the dose adjustor to the dose number you require in the visible window. Once the dose is set, squeeze the handle and lever and check the front of the piston is stopping at the required dose.

### ***VISIBLE DOSE***

Transparent graduated cylinder provides instant check of dose.

**FIGURE 1:  
EASY ACCESS**



**FIGURE 2:  
INLET VALVE SPRING  
ASSEMBLY**

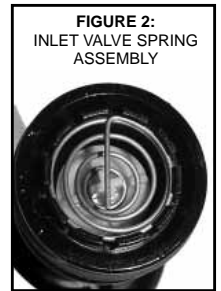

**FIGURE 3:  
DELIVERY VALVE  
SPRING ASSEMBLY**

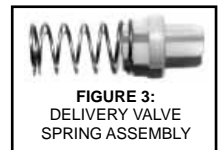

**FIGURE 4:  
DOSE SETTING**



## NEEDLE MOUNT & NUT

The injector is fitted with a metal needle mount and Luer lock nut. To fit the needle ensure the needle nut is screwed all the way on to the end of the cylinder. Locate your needle on to the mount and twist clockwise to lock it in to place. To remove the needle, twist it in an anticlockwise direction.

## INSTRUCTIONS FOR USE

1. Connect the handpiece to the container of material by means of the connecting tube and squeeze the lever several times to prime the instrument.



**PRIMING INSTRUMENT:** As this is a dial-a-dose instrument, the dose must be set at maximum to prime the instrument. This must be repeated every time a new container of material is used.



**Care must be taken to ensure the liquid does NOT come into contact with any part of the operators body. Chemicals may cause injury to the operator.**

2. The dose can be set from 0.5ml to 15ml in 0.5ml increments. The dose is very easily set. You simply turn the dose adjustor to the dose number you require in the visible window. Once the dose is set, squeeze the handle and lever and check the front of the piston is stopping at the required dose.
3. Check dosage accuracy. It is a wise practice to check the dose with each new container used. Use a measuring flask to test the dose.

## INJECTING

The injection attachment is designed for use with Luer needles only.

It is most important that the chosen site be clean — ideally swab the skin with surgical or methylated spirit. Read the chemical manufacturers' label and literature on dose rates and site of injection.

The following points are worth remembering.

1. Sterilize the instrument and needles (use cold water sterilant only – **DO NOT BOIL OR AUTOCLAVE**).
2. Always inject into loose skin.
3. After injecting massage the site to disperse the injected solution.

## AFTER INJECTING

1. Thoroughly flush equipment with a mild warm water detergent mix.
2. Flush again with clean water until all detergent is removed.
3. Draw a small quantity of NJ Phillips Lubricant into the cylinder through the inlet fitting.

## LUER LOCK NEEDLE FITTING



1. Position the needle in front of the needle nut.



2. Locate the needle onto the needle mount and turn clockwise to tighten.



3. The needle is now secured in place.

## NJ Phillips 15ml Injector (PAS1263)

1. Delivery Valve & Spring
2. Handle Clip
3. Inlet Valve & Spring
4. Piston O-Ring
5. Luer Needle Mount Assembly

**SPARE PARTS AVAILABLE:** Please order by Kit No. and Part Name.

KIT No.	PART NAME	ILLUSTRATION No.
WX1695	Service Kit	1,3,4.
WX1629A	Feed Tube Adaptor Kit	Not Illustrated.
WX1723	Luer Needle Mount Assembly	5.

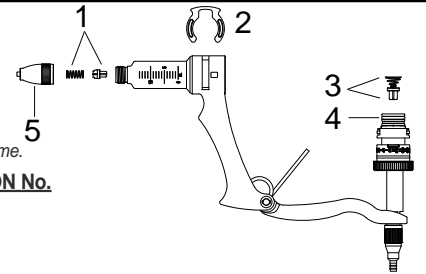

AS OUR POLICY IS ONE OF CONTINUOUS IMPROVEMENT THE MANUFACTURER RESERVES THE RIGHT TO ALTER THESE SPECIFICATIONS AT ANY TIME. ALL PRODUCTS PRODUCED BY NJ PHILLIPS PTY LIMITED, ARE IDENTIFIED BY A UNIQUE BATCH NUMBER. THIS IDENTIFICATION NUMBER IS AFFIXED TO THE PRODUCT TO ALLOW TRACEABILITY BY THE MANUFACTURER AND MUST NOT BE REMOVED IF PRODUCT INTEGRITY IS TO BE MAINTAINED.

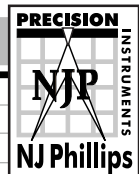

MADE IN AUSTRALIA

NJ PHILLIPS Pty Limited ABN 36 000 082 002

POSTAL ADDRESS: LOCKED BAG 8 GOSFORD NSW 2250 AUSTRALIA  
TELEPHONE: +61 2 4340 2044 FAX: +61 2 4340 1991  
EMAIL: njp1@njphillips.com.au

njphillips.com



PAS1263, PAD1331, PAD1263, PAM1323, PAM1324 | QL755-R7